



£ 440000

3 Bed House - Semi-Detached, Winchester Road, Basingstoke

Barons Estate Agents are delighted to offer to the market this extended 3 bedroom semi detached family home. On the ground floor the property offers an entrance hall, living room, kitchen/breakfast room, utility area and family room. On the first floor there are 3 bedrooms and a refitted family shower room. The property also offers driveway parking for a number of cars, a non overlooked rear garden as well as a double garage to the rear, that has been converted into an outbuilding, 2 storage areas and a single garage. Further benefits include double glazing, gas central heating and a sought after location within 1 mile of Basingstoke Town Centre. An early viewing is highly recommended by the owners sole agent.

Location

The property is situated within half of a mile of Basingstoke town centre and all of its amenities including Festival Place, which offers a host of shops, restaurants, 10 screen cinema and theatre. Kings Furlong Infant and Junior school is situated within a quarter of a mile along with local shops. The property also benefits from easy access to the M3 motorway and Basingstoke railway station to London Waterloo in 45 minutes.

Tenure

Freehold

Council Tax

Band D

Extra Services

Barons Estate Agents will recommend the services of other businesses and may receive a referral fee in some instances where a buyer or seller uses the services of that company.

🏠 KEY POINTS & FEATURES

- | | | |
|------------------------------------|--------------------------------|-------------------|
| 🏠 Semi Detached | 🏠 EXTENDED | 🏠 3 Bedrooms |
| 🏠 Bathroom | 🏠 Lounge | 🏠 Family Room |
| 🏠 Re Fitted Kitchen/Breakfast Room | 🏠 Private Enclosed Rear Garden | 🏠 Garage/Workshop |



GROUND FLOOR
1629 sq.ft. (151.3 sq.m.) approx.

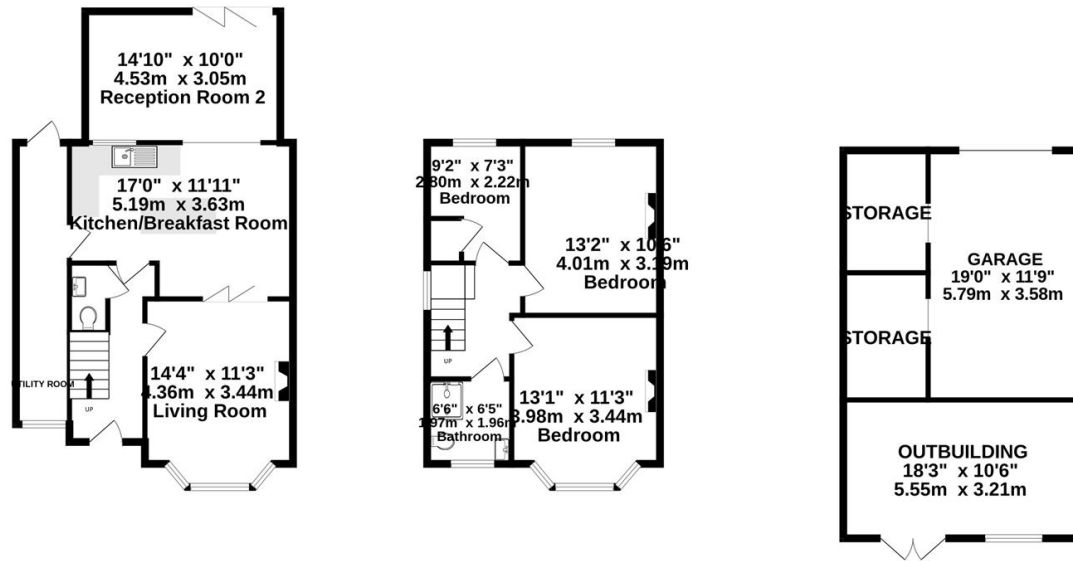

TOTAL FLOOR AREA : 1629 sq.ft. (151.3 sq.m.) approx.
Measurements are approximate. Not to scale. Illustrative purposes only
Made with Metropix ©2025